



**INSTRUCTIONS
FOR INSTALLATION
OF THE ROLLING GATES
AND ROLLED COVERS**



Before starting installation of the gate, please read the following instructions.

During transportation and storage, the gate should lie horizontally in a place protected from damage to the box. The gates should not be placed on the side wall.

Any modifications or changes to the design of the gates can only be made after consultation with the manufacturer. It is forbidden to start the motor equipped with an inertia brake before installing the gate. Starting the motor before installation may lead to permanent damage to the gate.

Gates should be installed on an even surface.

Directly before installation, unpack the gate and check if there are all elements necessary for its installation.

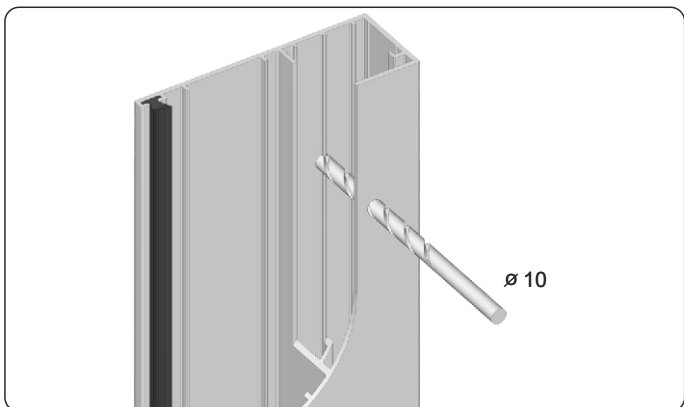

1. Drill holes in the guides. Using a 10 mm drill make a hole through two chambers of the guide.

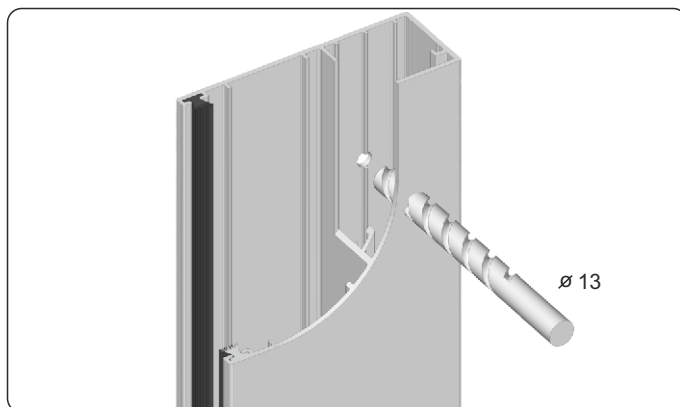

2. Using a 13mm drill increase the hole only in the first chamber from the outside of the guide.

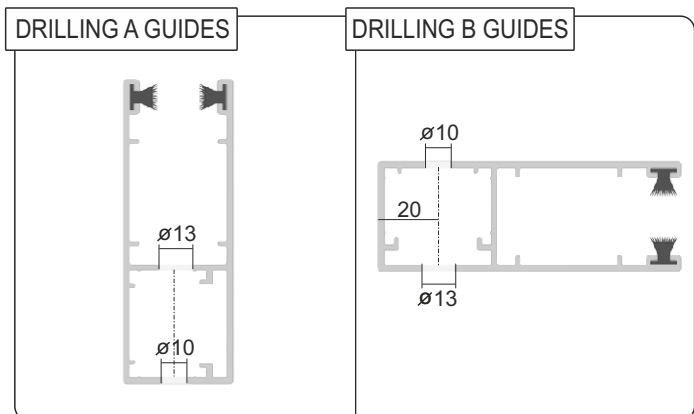

3. Location of mounting holes.

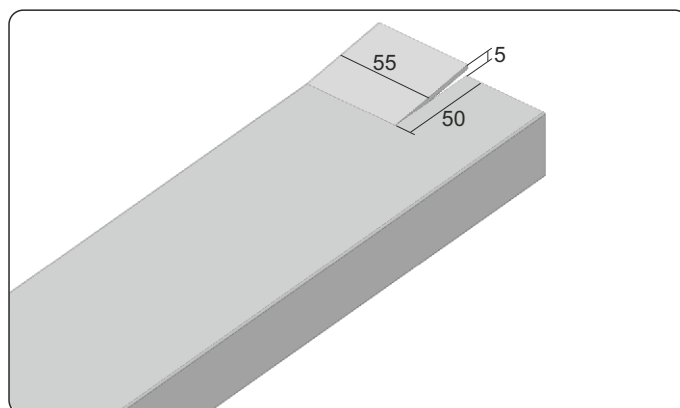

4. Unbend the cut wall by about 5mm so that the curtain can be passed through.

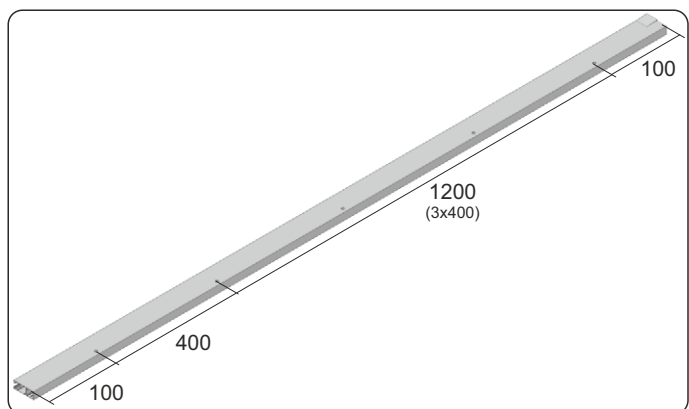

5. The hole spacing should not exceed 500mm.

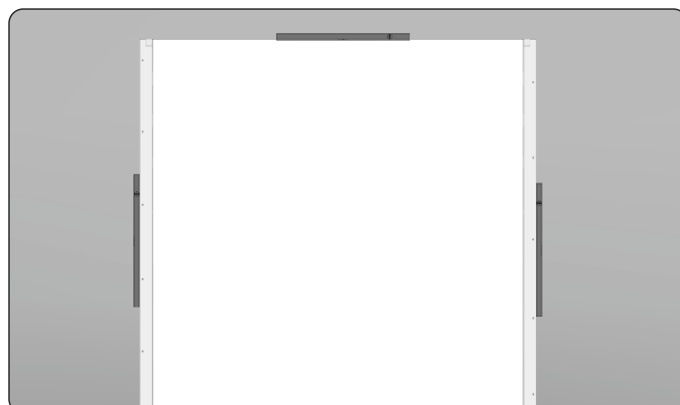

6. Put the guides against the ground and use a spirit level to set them vertically and parallel to one another.

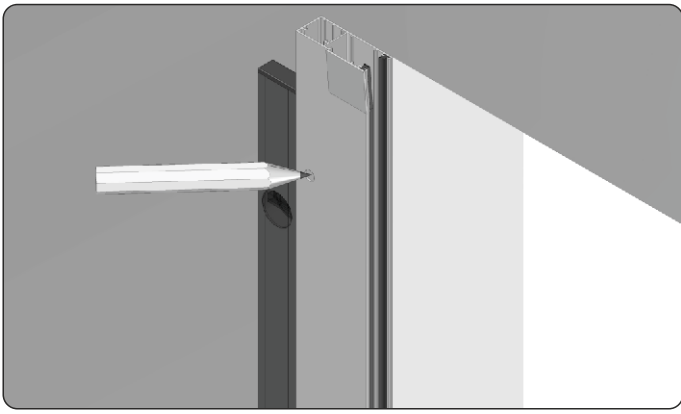

7. Mark holes for mounting pins.

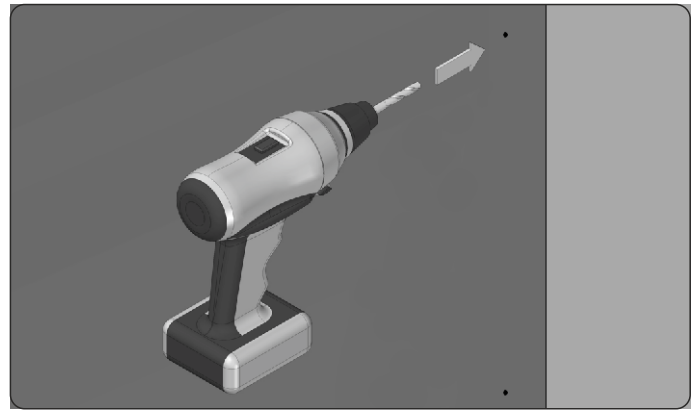

8. Drill the holes.

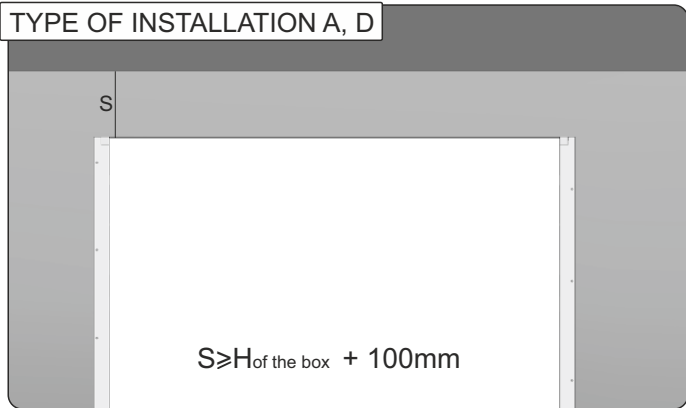

9. The minimum height S needed to install the gate box with the guides screwed is calculated by adding 100mm to the box height.

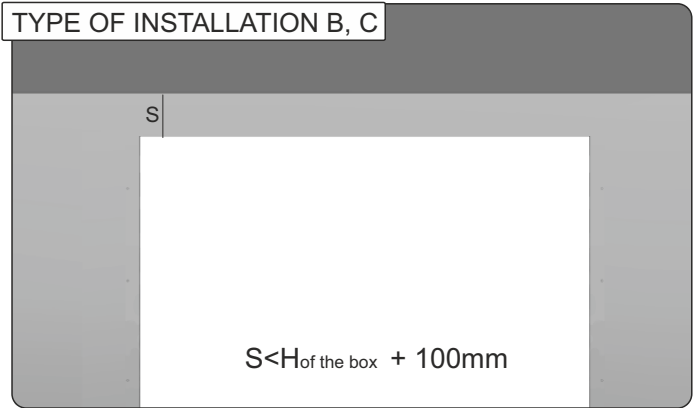

9a. If the height S is lower than the box H + 100mm, then the gate box should be installed on the guides (included).

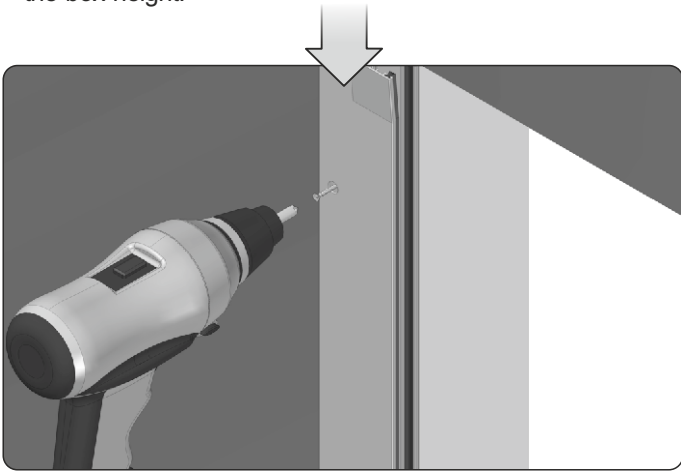

10. Screw the guides to the wall.

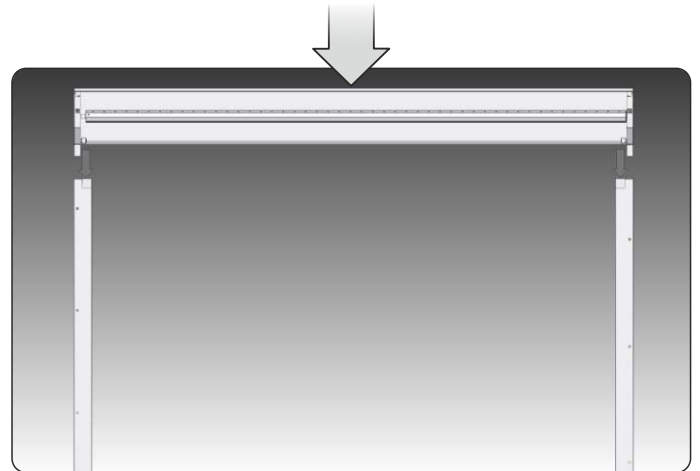

10a. Slide the box onto the guides.



11. Slide the box onto the screwed guides.



11a. Insert the complete set into the recess.

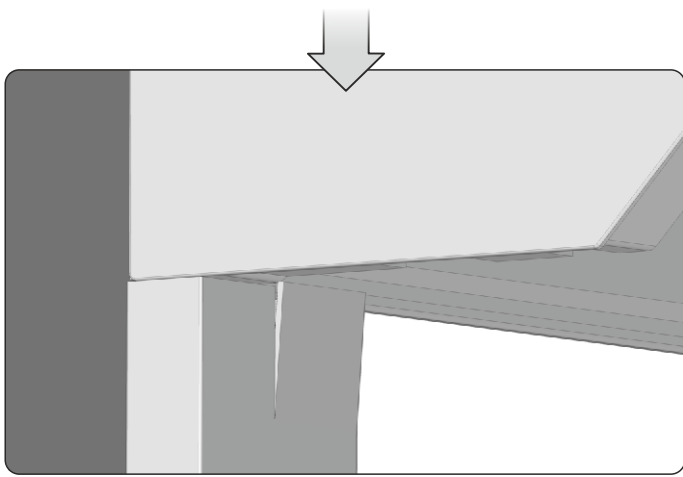

12. The side pins must be inserted to the very end of the guides.

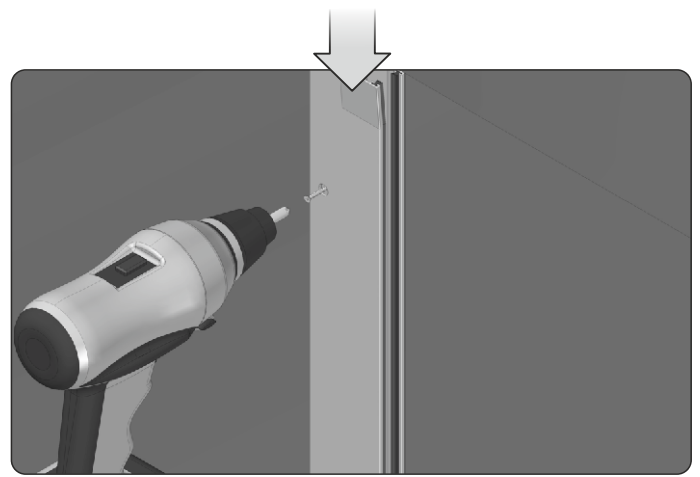

12a. Screw the guides to the wall.

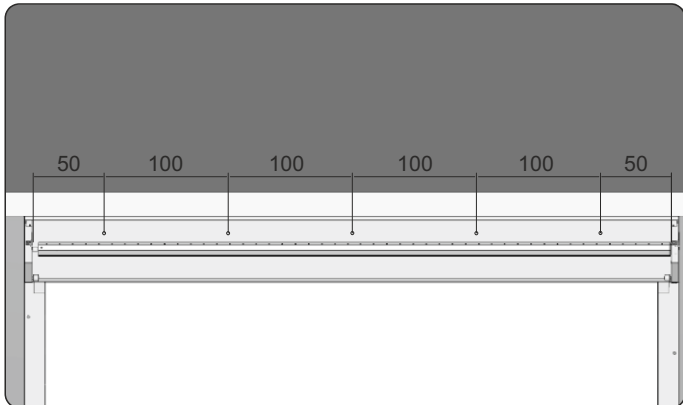

13. To prevent the box from sagging, screw its upper part to the wall with dowels. An example arrangement is shown in the figure.

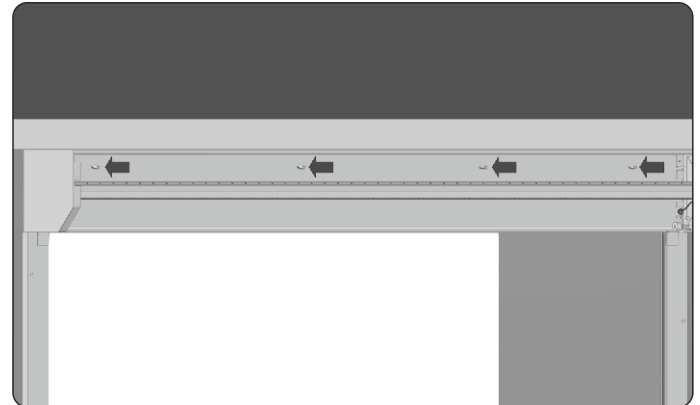

14. Insert the dowels in the drilled holes.

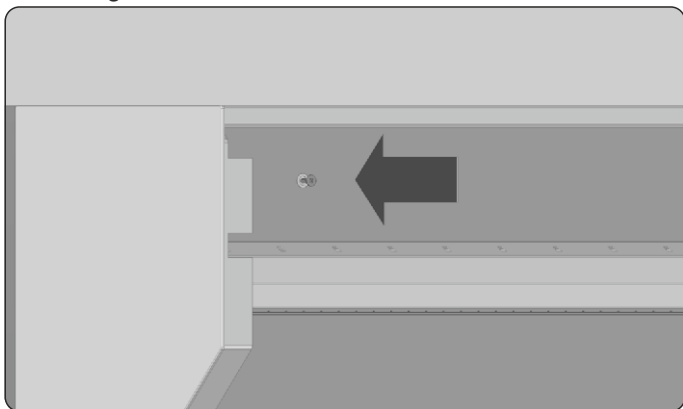

15. Screw the box with flat head screws.

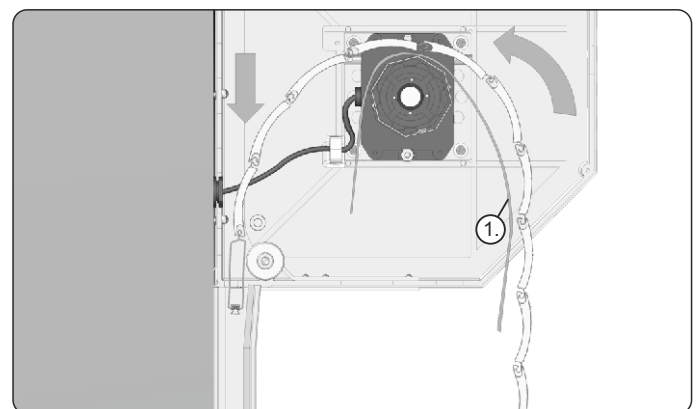

16. After checking the correct operation of the motor, insert the curtain through the roller pipe with the bottom lath down. **Before inserting the curtain, secure the roller pipe in order to avoid damaging the profiles (1).**

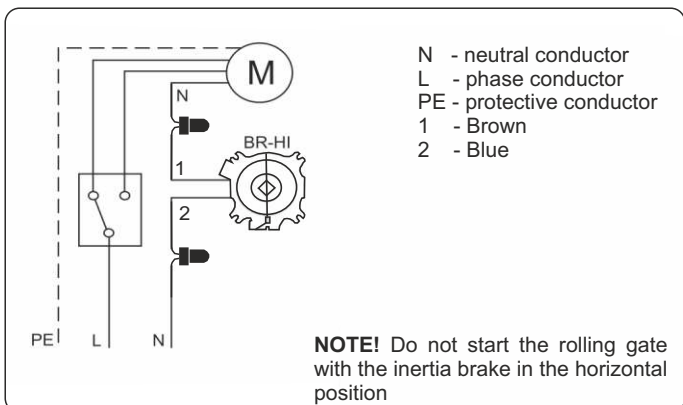

17. Electrical diagram for connecting an inertia brake.

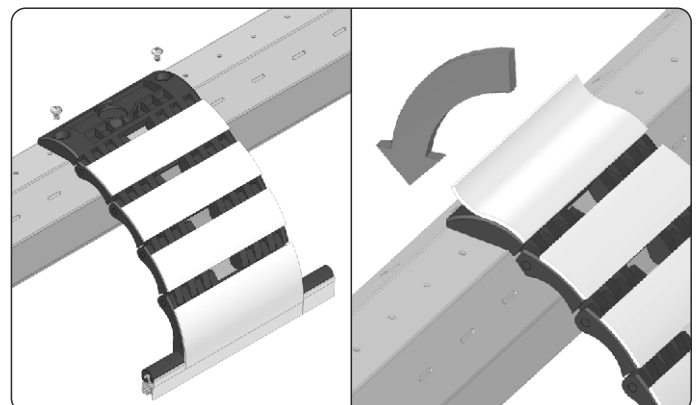

18. Hangers should be screwed to the roller pipe - two screws 3.9x8 for one hanger. After screwing the hanger, attach the felt end piece to the hanger with its entire surface.

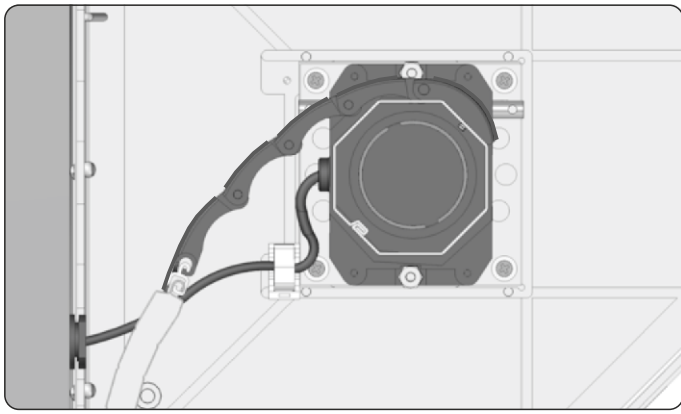

19. View of the properly installed hanger.

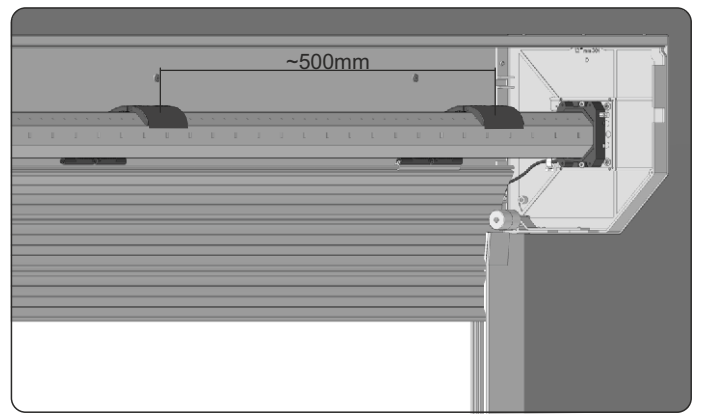

20. Hangers should be installed with a 500mm spacing.

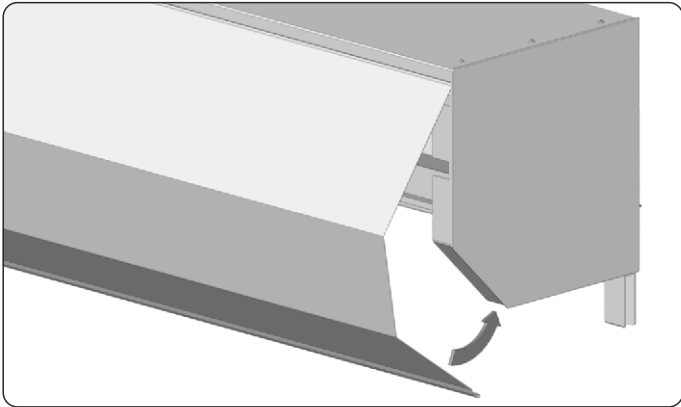

21. Install the inspection cover of the box.

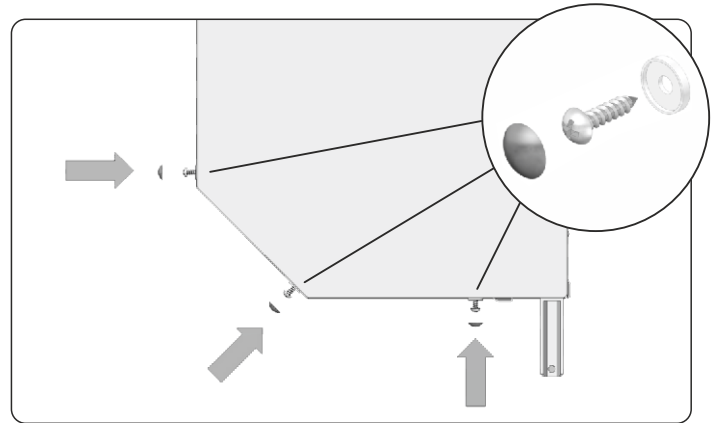

22. Screw on the inspection cover.

!!! NOTE !!!

The reasons for the improper operation of rolling gates and rolled covers.

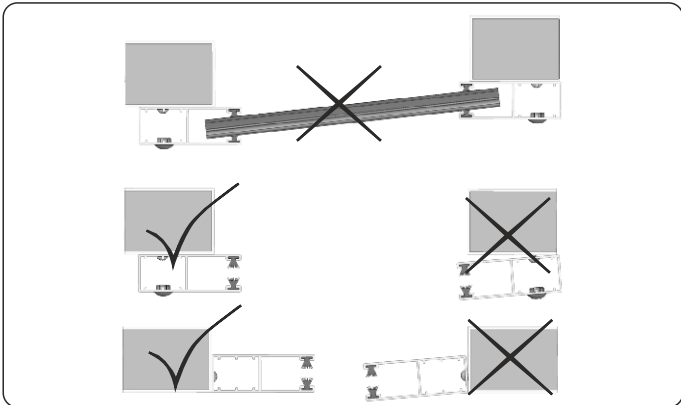

23. Examples of incorrect installation of guides in rolled covers.

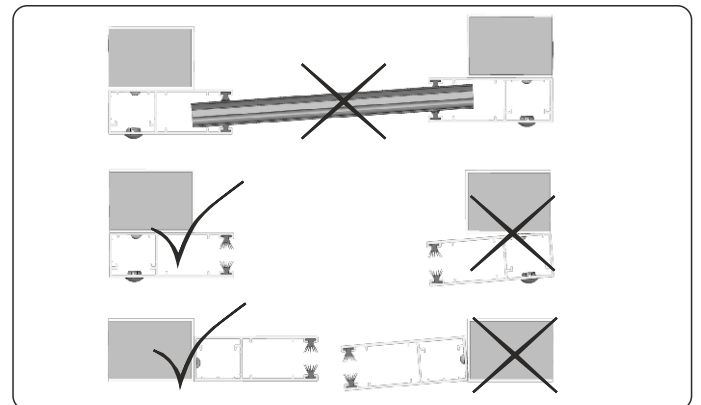

24. Examples of incorrect installation of guides in rolling gates.

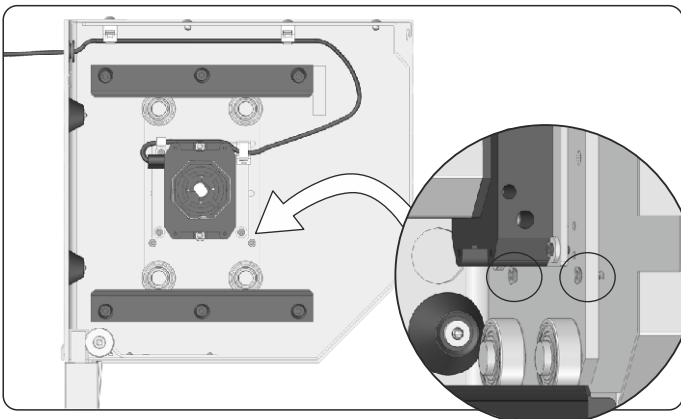

25. The console should not be blocked in any way, e.g. with screws.

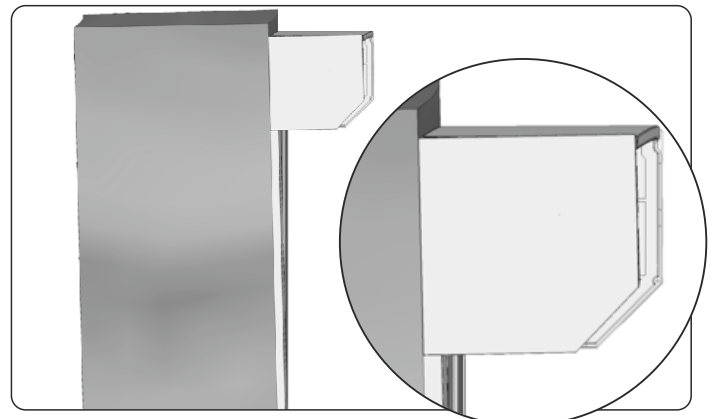

26. Rolling gates and rolled covers should not in any case be installed on uneven surfaces as this will deform the box and thus cause incorrect winding of the curtain profiles.

Operation and maintenance of the gate.

The rolling gate and its components have been designed in such a way that they will not be permanently deformed during proper use.

During use, follow the recommendations provided by the manufacturer.

The gate can be used at temperatures between -25°C and $+65^{\circ}\text{C}$.

Do not use the gate in case of the curtain icing.

Continuous operation of the gate should not exceed 4 minutes, the gate should be used up to 60 cycles per day. One cycle is defined as a full closure and full opening movement.

When activating the gate, within its operating range i.e. directly under the curtain, there should be no objects or persons disturbing the operation. When the gate is fully open, the bottom lath with the seal should always be in the side guides.

TO close and open the rolling gate, an electromechanical drive is used, which can be equipped with an emergency opening mechanism (crank with a hook provided with the gate). The crank is used only for emergency opening - it is unacceptable to use the crank as the main drive.

During the operation of the motor, when the supply voltage is on, it is not allowed to use the emergency opening (otherwise the drive may be damaged).

Inspection and maintenance work must be carried out at least every 3 months in accordance with these instructions. Basic maintenance operations can be performed by the rolling gate user with no special entitlements. These operations consist in removing particles of sand and other impurities from the curtain and the inside of the guides, that can lead to scratches on the gate components, as well as in visual inspection of the general condition of the gate, completeness control, condition and operational effectiveness of all structural elements.

When conducting maintenance operations, the following rules must be observed:

1. Maintenance must be carried out when the rolling gate is secured still, in this case it is advisable to disconnect the power supply for the time of conducting maintenance.
2. Do not use sharp or rough tools to clean the gate.
3. Do not use any viscous preservatives, such as spray grease.
4. Wash the surface of the gate with lukewarm water using mild cleaning agents with a neutral pH, preferably at the lowest temperature of $+10^{\circ}\text{C}$.

NOTE – detergents and caustic substances can damage or discolour the paint coat.

Any damage caused due to special weather conditions or natural wear cannot be claimed. Wear of the curtain paint coating in which fine scratches can be made after about 200 cycles, may be considered natural.

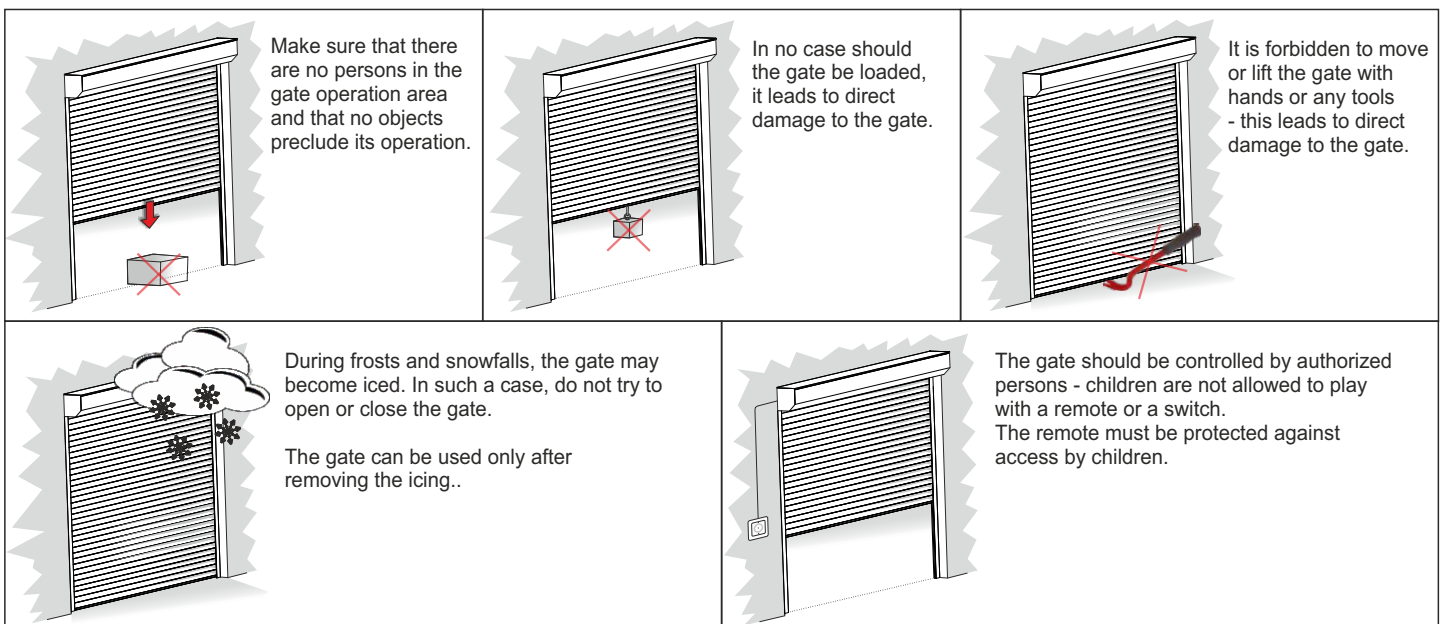

The PORTOS rolled cover is a constructional hole element that provides additional protection for the closed window or door recess. If installed in a different recess, it is not covered by the warranty.

The protective foil should be removed within 3 weeks from the date of installation, but no later than 2 months from the date of receipt of the goods from the roller shutter manufacturer.

During frosts, the roller shutters can freeze. Then, it is necessary to avoid sudden pulling and not to open or close the deeply frozen roller shutters.

Damage caused as a result of not complying to the above-mentioned recommendations shall not be recognized.



**WARNING - FOLLOWING THESE
INSTRUCTIONS IS IMPORTANT FOR THE SAFETY OF PERSONS.
KEEP THESE INSTRUCTIONS.**



PORTOS TR7

spółka z ograniczoną odpowiedzialnością s. k.

ul. Złota 71
62-800 Kalisz
tel 62 768 40 11

E-mail: sekretariat@portosrolety.pl
www.portosrolety.pl



PN-EN 13241

The declaration of performance is available at
na stronie www.portos.company